



**DNE445-460M8-72H**

**12  
Years**

**12 Years quality assurance of materials and craftsmanship**

**25  
Years**

**25 Years 80% output power guarantee**

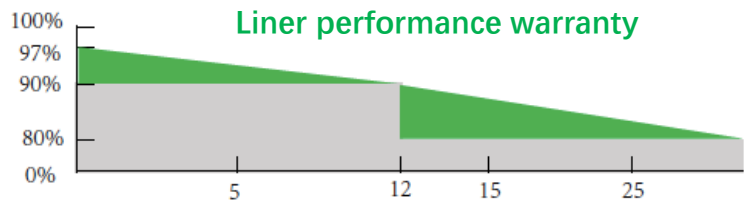

**Qualifications and Certificates**



**Key Features**

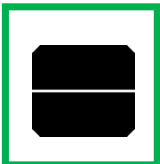

**High Efficiency Solar Module**

Half-cut cells with lower internal current and lower internal resistance losses

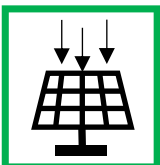

**Strong Mechanical Load Frame**

Mechanical load capacity up to 5400pa

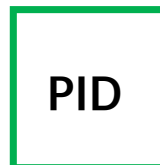

**Excellent Anti-PID Performance**

The performance of PID resistance (Potential Induced Degradation) passed the standard TUV



**100% EL Testing**

Each solar panel passes two Electroluminescence (EL) inspections

## Electrical Data (STC)

\* STC: Irradiance 1000W/m<sup>2</sup>, Module Temperature 25°C, AM 1.5

Module Type	DNE445M8-72H	DNE450M8-72H	DNE455M8-72H	DNE460M8-72H
Peak Power (Pmax)	445	450	455	460
Maximum Power Voltage (Vmp)	41.28	41.47	41.70	41.91
Maximum Power Current (Imp)	10.78	10.85	10.91	10.98
Open Circuit Voltage (Voc)	49.28	49.51	49.75	49.99
Short Circuit Current (Isc)	11.48	11.56	11.62	11.69
Module Efficiency (%)	20.5	20.70	20.90	21.20
Maximum Power Tolerance	0-5W	0-5W	0-5W	0-5W

## Electrical Data (NOCT)

\* NOCT: Irradiance 800W/m<sup>2</sup>, Ambient Temperature 20°C, AM 1.5, Wind speed 1 m/s

Module Type	DNE445M8-72H	DNE450M8-72H	DNE455M8-72H	DNE460M8-72H
Peak Power (Pmax)	341.86	345.70	349.54	353.38
Maximum Power Voltage (Vmp)	37.63	37.81	37.99	38.19
Maximum Power Current (Imp)	9.09	9.14	9.20	9.25
Open Circuit Voltage (Voc)	45.50	45.73	45.96	46.19
Short Circuit Current (Isc)	9.77	9.83	9.89	9.94

## Temperature & Maximum rating

Temperature Coefficients Isc (A/°C)	+0.046%/°C
Temperature Coefficients Voc (V/°C)	-0.276%/°C
Temperature Coefficients Pmax (W/°C)	-0.381%/°C
NOCT (°C)	45±2°C
Operating and Storage Temperature (°C)	-40°C ~ +85°C
Maximum System Voltage (V)	1500V
Maximum Series Fuse Rating (A)	20A
Max Wind Load/Snow Load	2400Pa/5400Pa
Application Class	A

## PV Drawing

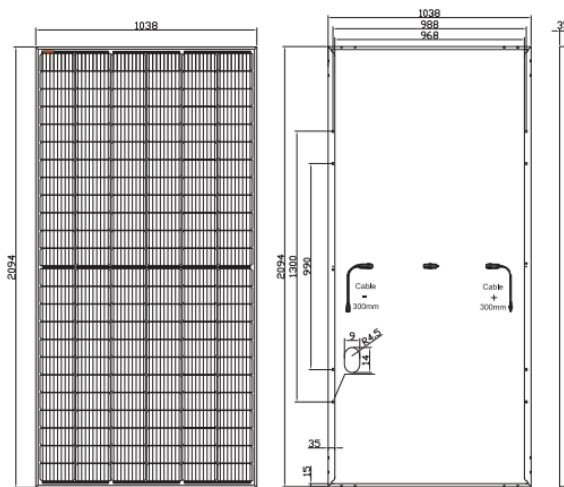

## Mechanical Characteristics

Cell type	166*83 Mono
Cells Number	144 (12*12)
Dimensions	2094*1038*35mm
Weight	24.0kgs
Front Glass	3.2mm high transmission, tempered glass
Frame	Anodized Aluminum Alloy
Junction Box	IP67/IP68, 3 bypass diodes
Output Cables	4mm <sup>2</sup> , 300mm in length each
Connector	compatible with MC4 plug

## IV Curve

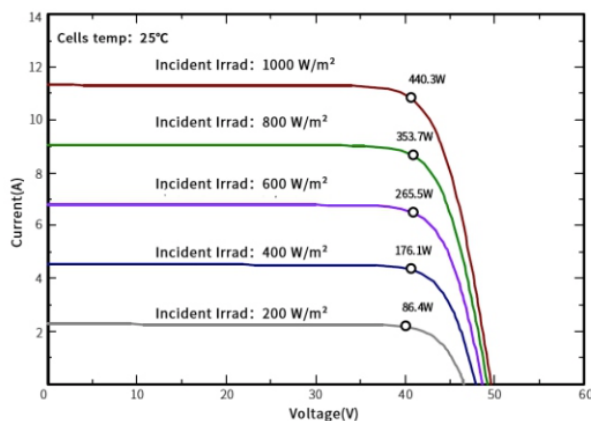

## Packing information

20FT Container	155PCS/5Pallets
40HQ Container	726PCS/22Pallets