

PV Drawing

DNE200P-24

Electrical Data (STC)

Module Type	DNE200P-24
Peak Power (Pmax)	200
Maximum Power Voltage (Vmp)	24.81
Maximum Power Current (Imp)	8.06
Open Circuit Voltage (Voc)	29.59
Short Circuit Current (Isc)	8.63
Module Efficiency (%)	15.19
Maximum Power Tolerance	0-5W

* STC: Irradiance 1000W/m², Module Temperature 25°C, AM 1.5

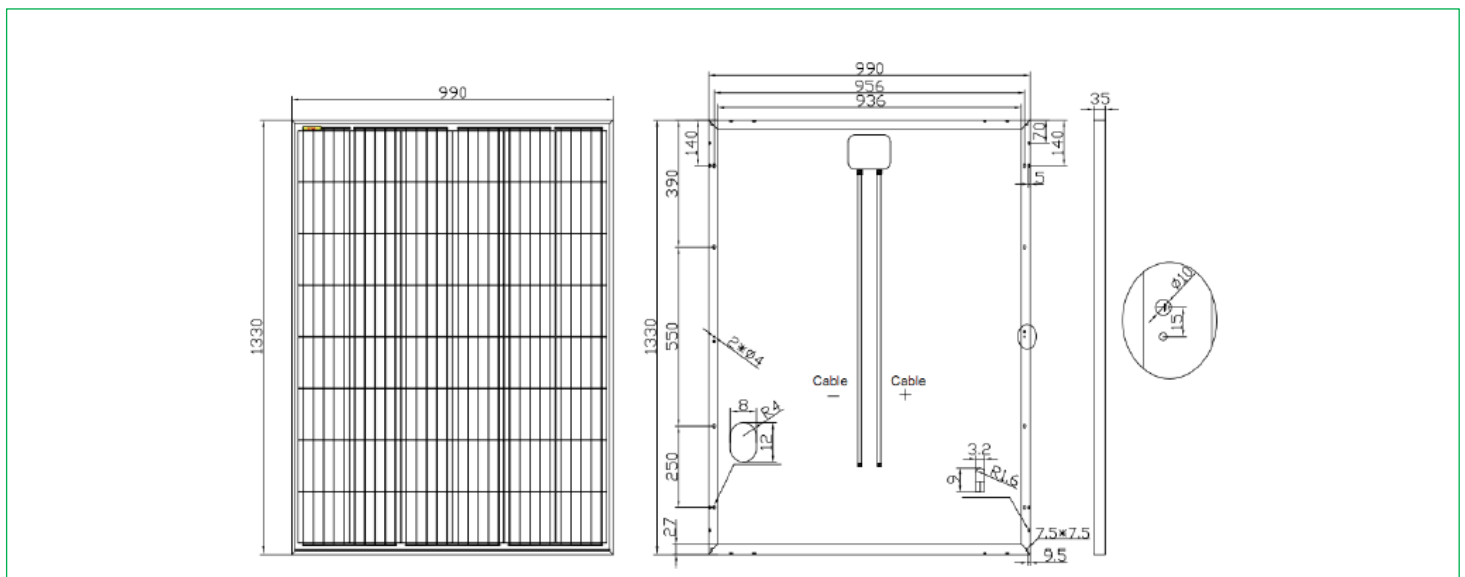

Mechanical Characteristics

Cell type	156*156 Mono
Cells Number	48 (6*8)
Dimensions	1330*990*35mm
Weight	15.4kgs
Front Glass	3.2mm high transmission, tempered glass
Frame	Anodized Aluminum Alloy
Junction Box	IP67/IP68
Output Cables	4mm ² , 900mm in length each
Connector	compatible with MC4 plug

Temperature & Maximum rating

Temperature Coefficients Isc (A/°C)	+0.050%/°C
Temperature Coefficients Voc (V/°C)	-0.320%/°C
Temperature Coefficients Pmax (W/°C)	-0.410%/°C
NOCT (°C)	45±2°C
Operating and Storage Temperature (°C)	-40°C ~ +85°C
Maximum System Voltage (V)	1000V
Maximum Series Fuse Rating (A)	30A
Max Wind Load/Snow Load	2400Pa/5400Pa
Application Class	A

