



## DNE100M-18

### Electrical Data (STC)

Module Type	DNE100M-18
Peak Power (Pmax)	100
Maximum Power Voltage (Vmp)	18.78
Maximum Power Current (Imp)	5.32
Open Circuit Voltage (Voc)	22.64
Short Circuit Current (Isc)	5.70
Module Efficiency (%)	14.90
Maximum Power Tolerance	0-5W

### PV Drawing

\* STC: Irradiance 1000W/m<sup>2</sup>, Module Temperature 25°C, AM 1.5

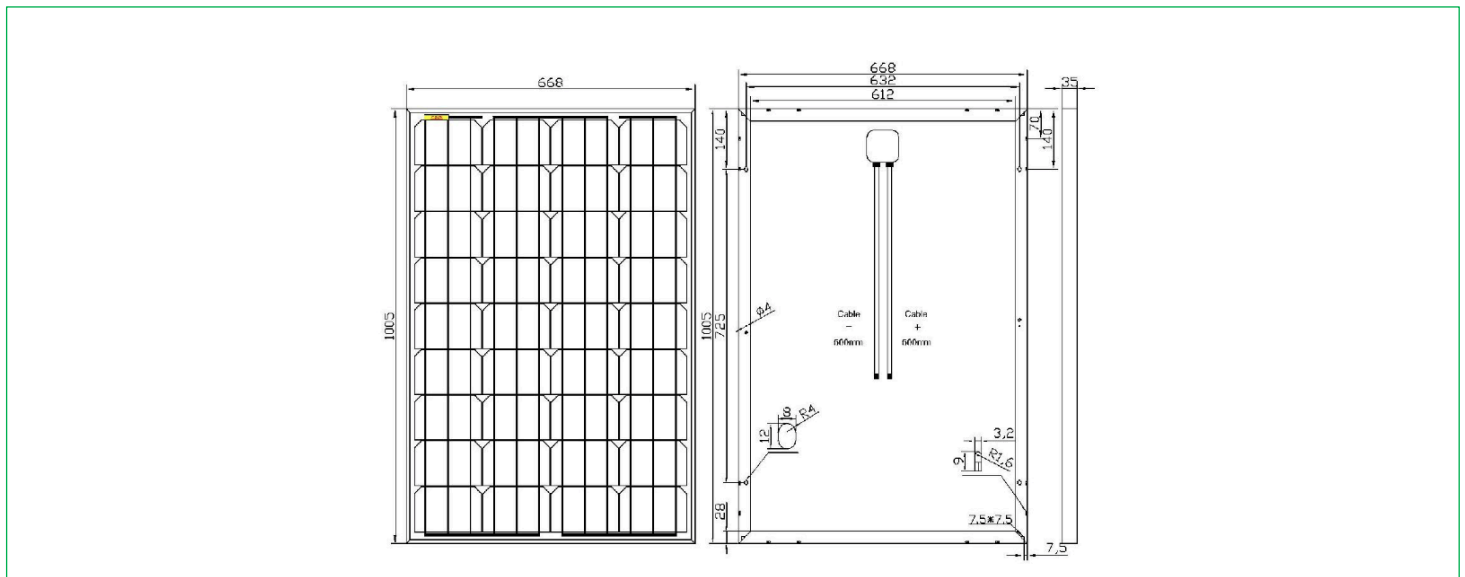

### Mechanical Characteristics

Cell type	156*104 Mono
Cells Number	36 (4*9)
Dimensions	1005*668*35mm
Weight	8.0kgs
Front Glass	3.2mm high transmission, tempered glass
Frame	Anodized Aluminum Alloy
Junction Box	IP67/IP68
Output Cables	2.5mm <sup>2</sup> , 500mm in length each
Connector	compatible with MC4 plug

### Temperature & Maximum rating

Temperature Coefficients Isc (A/°C)	+0.040%/°C
Temperature Coefficients Voc (V/°C)	-0.380%/°C
Temperature Coefficients Pmax (W/°C)	-0.470%/°C
NOCT (°C)	45±2°C
Operating and Storage Temperature (°C)	-40°C ~ +85°C
Maximum System Voltage (V)	1000V
Maximum Series Fuse Rating (A)	10A
Max Wind Load/Snow Load	2400Pa/5400Pa
Application Class	A

